



**Inspections LLC**

# **RADON INSPECTION REPORT**

Document Generated

**03/25/2022**

Document Number

**RP22112070023\_08Feb22\_1813**



Test Performed For  
**Sample report**

Device S/N

**RP22112070023**

Measurement Date

**02/08/2022 - 02/10/2022**

Inspection Duration

**48 hour (Data No: 48)**

Measurement Location

**Sample location  
Portland, Oregon 97229**

Inspector

**Michael Cortes**

Inspector Phone

**5038514111**

Inspector Address

**MCC Inspections  
Beaverton, Oregon 97007**

# MEASUREMENT ENVIRONMENTS



Test Started  
02/08/2022 18:13

Test Ended  
02/10/2022 18:13

Inspection Duration  
48 hours

Calibrated  
12/07/2021

Wait Time  
0 hour

Radon Concentration max  
2.1

Radon Concentration min  
0.6

Overall Avg  
1.4

EPA Protocol Avg  
1.4

*NOTE: The calculated EPA average excludes the first 4 hrs measures to follow EPA protocol.*

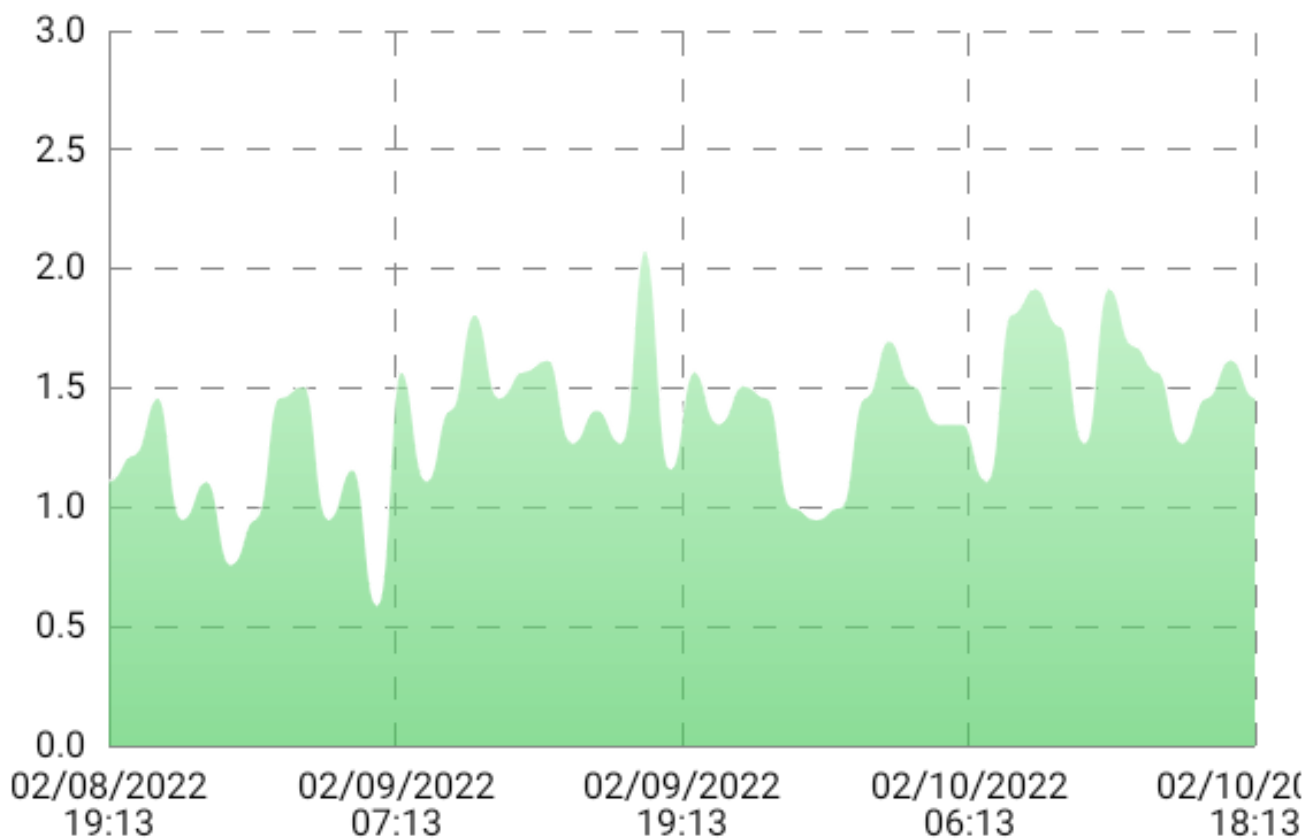

COMMENTS

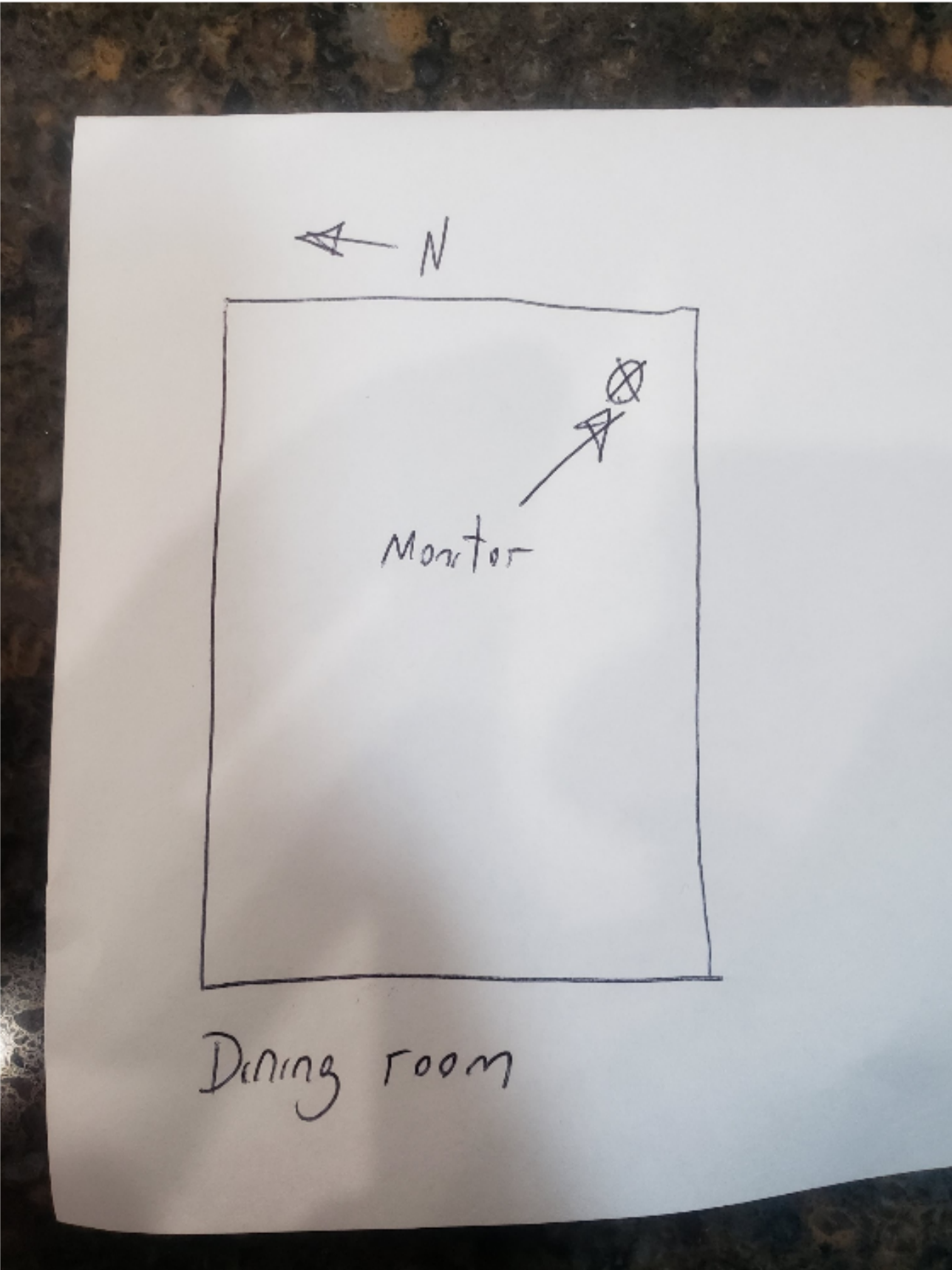

# Table of Hourly Radon Measurements

**Radon Concentration Average: 1.4 pCi/ℓ**

Timestamp	Radon Value	Temp(F)	RH(%)	Timestamp	Radon Value	Temp(F)	RH(%)
02/08/22 07:13	1.1	66	49	02/09/22 07:13	1.6	68	45
02/08/22 08:13	1.2	66	46	02/09/22 08:13	1.4	67	44
02/08/22 09:13	1.5	66	45	02/09/22 09:13	1.5	67	44
02/08/22 10:13	0.9	65	44	02/09/22 10:13	1.5	66	44
02/08/22 11:13	1.1	64	43	02/09/22 11:13	1.0	65	43
02/09/22 12:13	0.8	64	43	02/10/22 12:13	0.9	64	43
02/09/22 01:13	0.9	63	43	02/10/22 01:13	1.0	64	42
02/09/22 02:13	1.5	62	42	02/10/22 02:13	1.5	63	42
02/09/22 03:13	1.5	62	42	02/10/22 03:13	1.7	62	42
02/09/22 04:13	0.9	61	42	02/10/22 04:13	1.5	61	42
02/09/22 05:13	1.2	60	42	02/10/22 05:13	1.4	61	42
02/09/22 06:13	0.6	60	42	02/10/22 06:13	1.4	60	42
02/09/22 07:13	1.6	59	42	02/10/22 07:13	1.1	60	43
02/09/22 08:13	1.1	59	42	02/10/22 08:13	1.8	59	43
02/09/22 09:13	1.4	58	43	02/10/22 09:13	1.9	59	43
02/09/22 10:13	1.8	58	43	02/10/22 10:13	1.8	59	44
02/09/22 11:13	1.5	59	43	02/10/22 11:13	1.3	58	44
02/09/22 12:13	1.6	58	43	02/10/22 12:13	1.9	58	44
02/09/22 01:13	1.6	59	43	02/10/22 01:13	1.7	58	44
02/09/22 02:13	1.3	64	43	02/10/22 02:13	1.6	63	43
02/09/22 03:13	1.4	67	42	02/10/22 03:13	1.3	66	42

\* Temperature and humidity can vary depending on environmental conditions.